

User Manual

LCD Monitor Arm

LA-911.LA-921 .

LA-912.LA-922 <<<

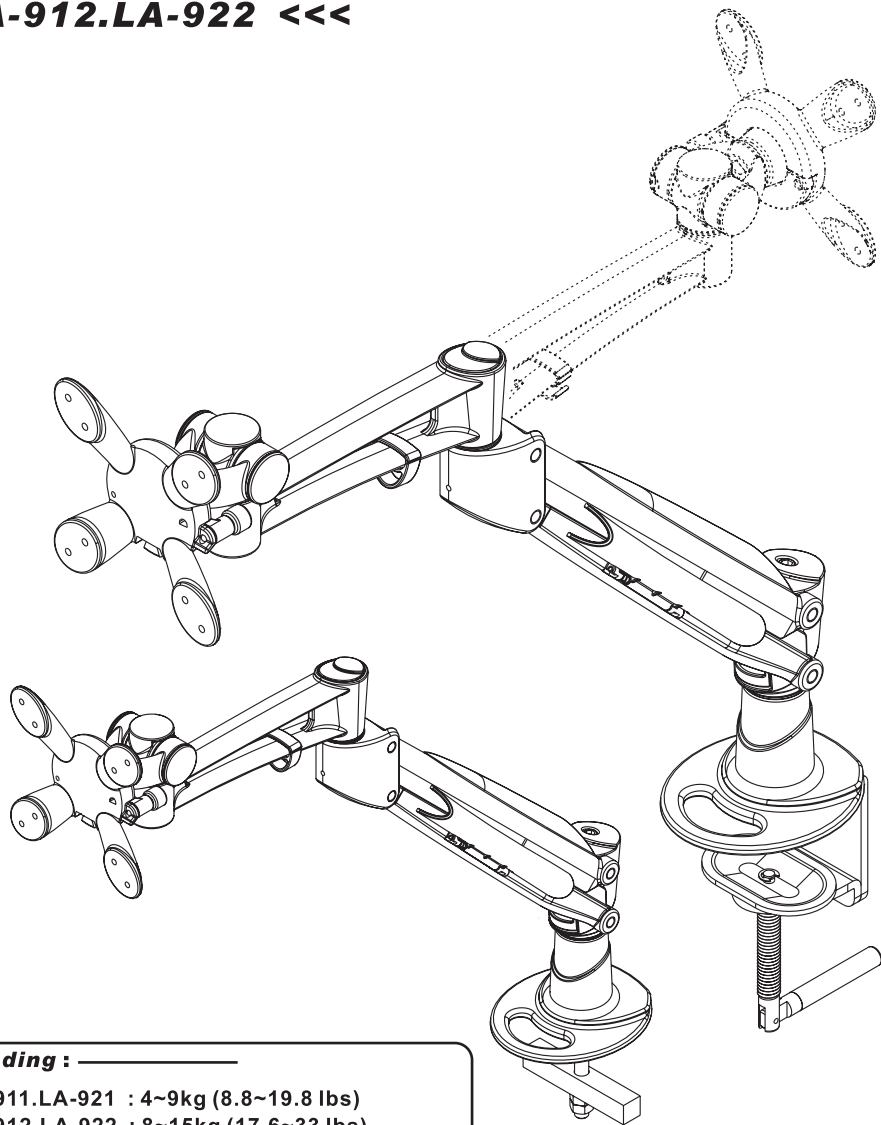

Loading :

LA-911.LA-921 : 4~9kg (8.8~19.8 lbs)
 LA-912.LA-922 : 8~15kg (17.6~33 lbs)

2009.05.

Check - list

Before assembly please spend some time to read this and follow the procedures step by step. Some panels are viewed differently from the detail drawing below. This is for extra clarity. Do not discard any of the packaging until you have checked all the parts and the package of fittings. If you miss any of the parts, please contact the store where you purchased your products. The staff will do their best to help you .

LA-911.LA-912

Part Check-List

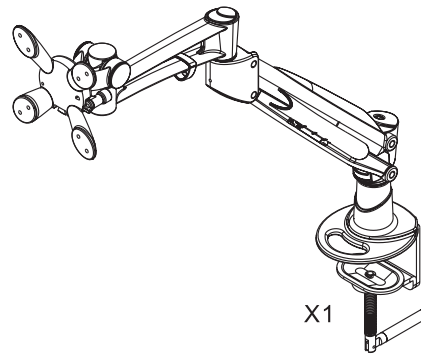

Fitting / Tools Check-List

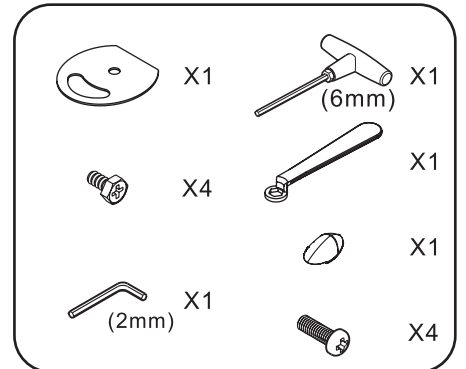

LA-921.LA-922

Part Check-List

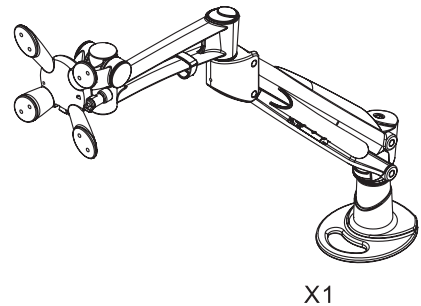

Fitting / Tools Check-List

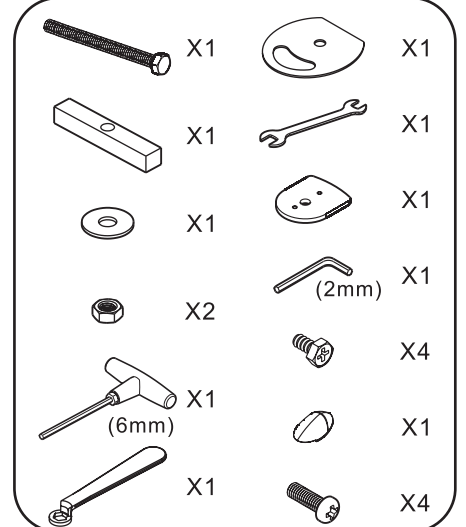

Assembly Guide

01

Step 1

LA-911. LA-912

"Clamp" assembly step

Adhere the pad to the clamp base. Desk thickness from 20mm~50mm. Then fix the clamp on the desk.

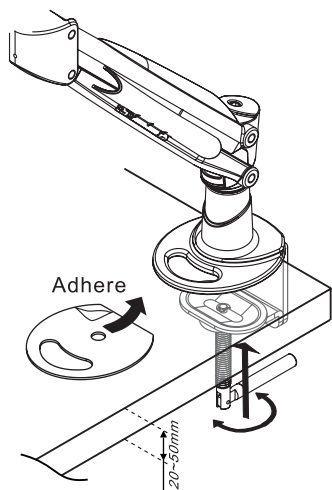

Step 1

LA-921.LA-922

"Grommet" assembly step(1-1)

Use 2mm allen key to lose screw, Then take out the arm up.

Notice:
Don't make the screw drop.

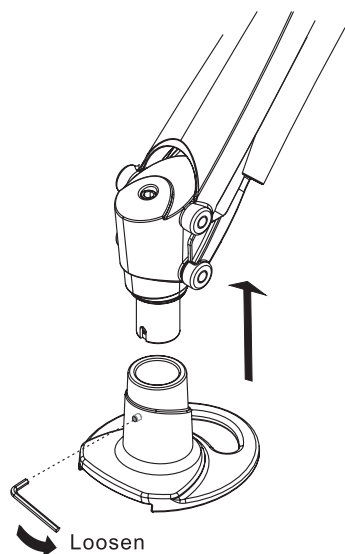

Assembly Guide

02

Step 1

LA-921.LA-922

"Grommet" assembly step(1-2)

To assemble the small metal plate on the bottom concavity of the grommet set then adhere the pad to the grommet set which is touch with desk surface. Then fix the grommet set on the desk through a bolt and parts (as figures below). Desk thickness from 20mm~50mm. The diameter of the hole is from 20mm to 50mm.

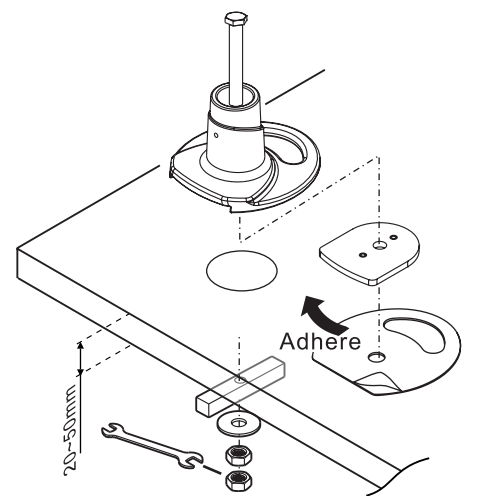

Step 1

LA-921.LA-922

"Grommet" assembly step(1-3)

Fix the grommet mount on the desk. Use 2mm allen key to secure the pole and the grommet mount with the screw to the bottom, and than move backward 1 circle.

Note:
Before secure the screw please make sure a concavity which on the bottom of the arm if aim at the small hole position together.

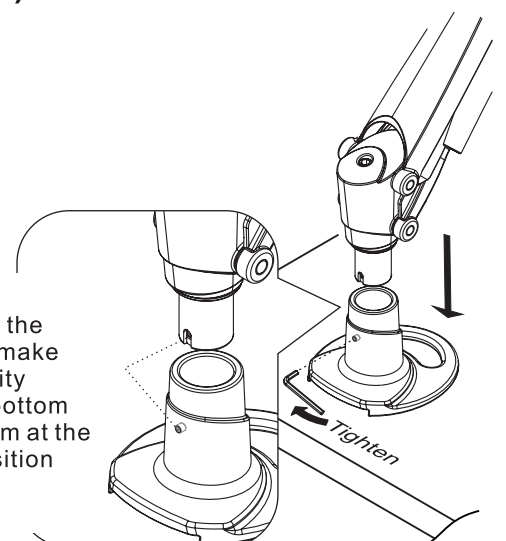

Assembly Guide

03

Step 2

Move the knob out first then pull it down to open the VESA adapter plate switch then take it up from the arm.

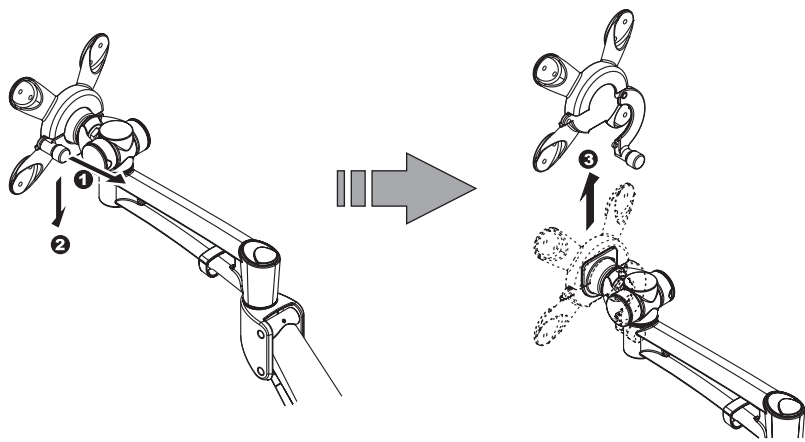

Step 3

Place LCD with facing downward on flat surface. Place VESA adapter plate on the LCD back as figure and align to the screw holes. Secure them together with four screws. And then tighten them up with screwdriver(not provided).

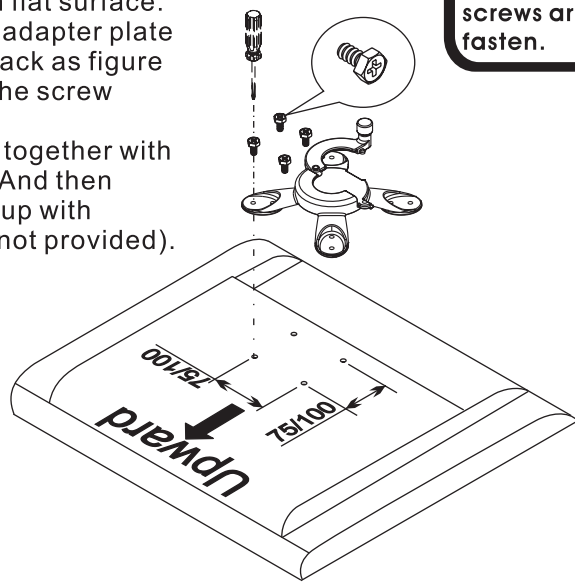

•These screws (M4/15L) are just for special monitor when the original screws are too short to fasten. X4

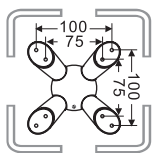

75mmx75mm
100mmx100mm
VESA interface.

Assembly Guide

04

Step 4

Insert the VESA adapter plate(with LCD display on already)into the arm and press it down. Then push the knob up.(as figure)

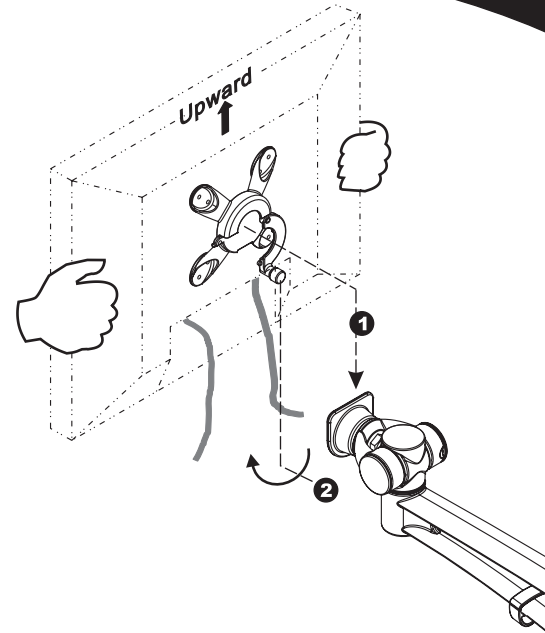

Step 5

(1)Use cable tie supplied to finish cable management.

(2)Move the cable cover up then to open it for finish cable management.

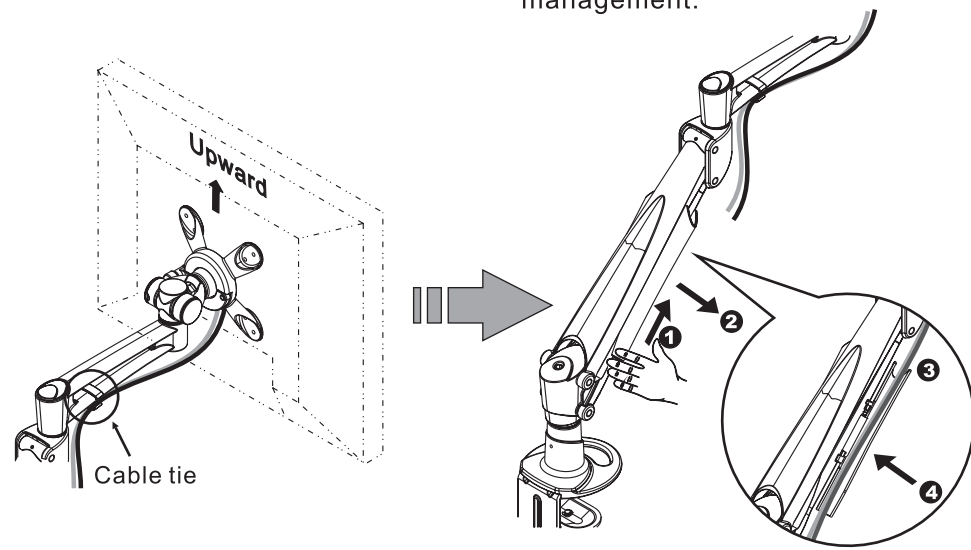

Assembly Guide

05

Adjustment For Loading

Caution for weight capacity adjustment:

- 1.Make sure of the LCD panel weight.
- 2.Support arm with a hand during assembly.

Adjustment:

Use the Allen key provided to adjust the weight capacity. Twist the Allen key in a clockwise direction for less weight; counterclockwise direction for more weight.

- LA-911. LA-921: 4~9 kg (8.8~19.8 lbs)
- LA-912. LA-922: 8~15 kg (17.6~33 lbs)

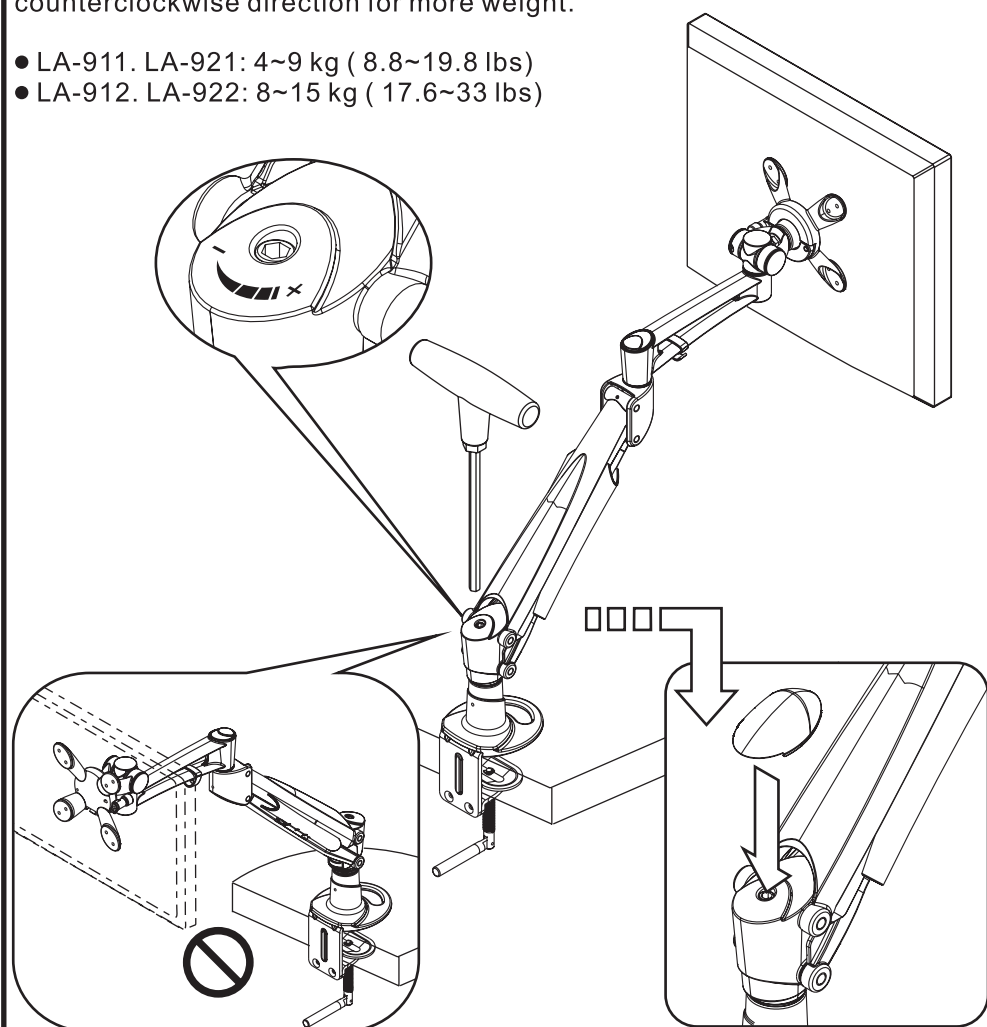

Assembly Guide

06

Adjusting Universal Joint Tension

When assembling the arm with monitors of differing weights, you may find that the tension of the universal joint needs to be adjusted to ease movement or to maintain the desired monitor position. If so, adjust as follows:

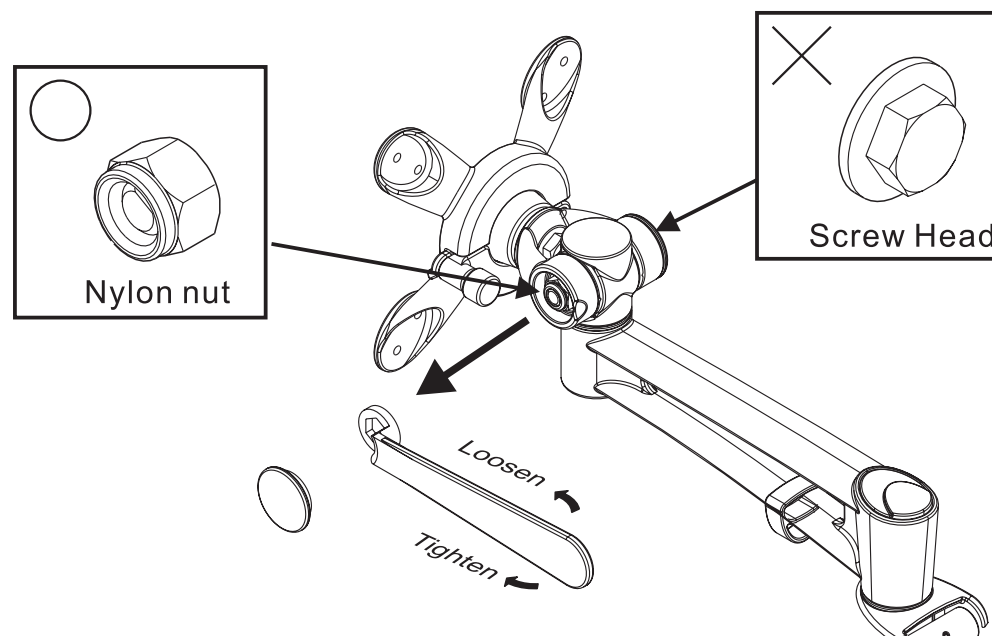

- Remove the plastic universal joint cover.
- Find the nylon nut (not the screw head) and use the included wrench to adjust the tension.
- Use one hand to support the monitor and adjust the tension of the universal joint.
 - Clockwise : more tension
 - Counterclockwise : less tension
- When the desired tension is achieved, replace the plastic cover.

Caution:

- Support the monitor during the adjustment procedure.
- Only adjust the nylon nut (not the screw head).
- Do not disassemble the universal joint .